

# Missouri Valley Complex Committee

## Agenda

MVCC Committee Meeting  
Tuesday April 23, 2024- 12:00 noon  
Tom Baker Room

Presiding: Commissioner Wayne Munson, Burleigh County Commission

- Item 1. Welcome and Introductions of Committee Members
- Item 2. Overview of MVCC  
Formation and Purpose  
Tasks and Responsibilities  
  
Discussion
- Item 3. Election and seating of MVCC Officers  
Chair, Vice Chair, Secretary/Coordinator
- Item 4. Seating of MVCC Chair
- Item 4A. Presiding – MVCC Chair
- Item 5. MVCC Discussion
  - Structure and Accountability
  - Relationship to County Commission
  - Meeting Protocol
  - Review of Current Leases and Use Agreements
  - MVCC Coordination
  - Development of Burleigh County Web Site and MVCC Meeting Schedule
- Item 8. Stakeholder Update – Buck Stop Junction
- Item 9. Next Meeting
- Item 10. Meeting Adjourned





**BURLEIGH COUNTY, NORTH DAKOTA**  
**MISSOURI VALLEY COMPLEX OWNERSHIP AND LEASES**

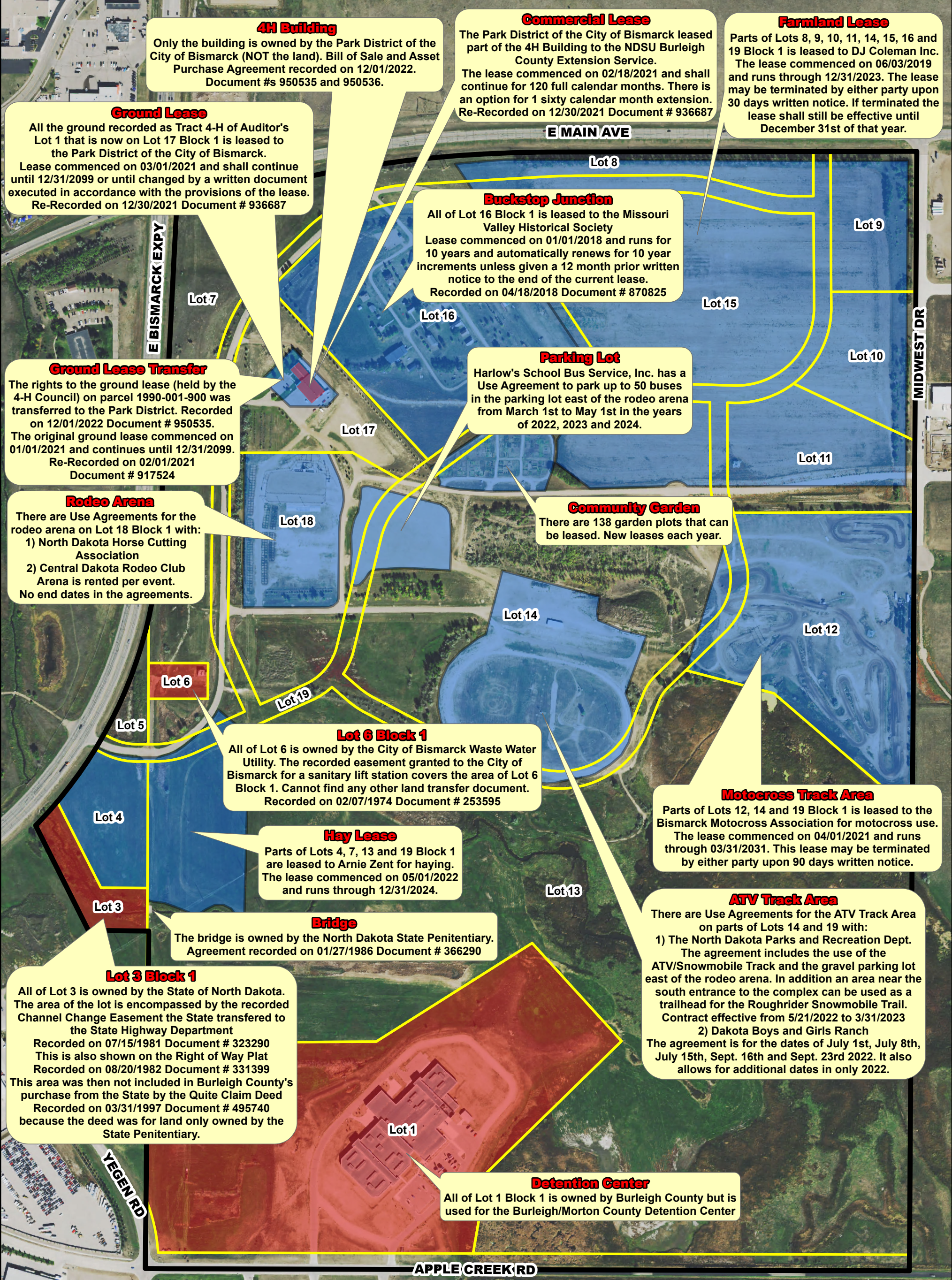

**4H Building**  
 Only the building is owned by the Park District of the City of Bismarck (NOT the land). Bill of Sale and Asset Purchase Agreement recorded on 12/01/2022. Document #s 950535 and 950536.

**Commercial Lease**  
 The Park District of the City of Bismarck leased part of the 4H Building to the NDSU Burleigh County Extension Service. The lease commenced on 02/18/2021 and shall continue for 120 full calendar months. There is an option for 1 sixty calendar month extension. Re-Recorded on 12/30/2021 Document # 936687

**Farmland Lease**  
 Parts of Lots 8, 9, 10, 11, 14, 15, 16 and 19 Block 1 is leased to DJ Coleman Inc. The lease commenced on 06/03/2019 and runs through 12/31/2023. The lease may be terminated by either party upon 30 days written notice. If terminated the lease shall still be effective until December 31st of that year.

**Ground Lease**  
 All the ground recorded as Tract 4-H of Auditor's Lot 1 that is now on Lot 17 Block 1 is leased to the Park District of the City of Bismarck. Lease commenced on 03/01/2021 and shall continue until 12/31/2099 or until changed by a written document executed in accordance with the provisions of the lease. Re-Recorded on 12/30/2021 Document # 936687

**Buckstop Junction**  
 All of Lot 16 Block 1 is leased to the Missouri Valley Historical Society Lease commenced on 01/01/2018 and runs for 10 years and automatically renews for 10 year increments unless given a 12 month prior written notice to the end of the current lease. Recorded on 04/18/2018 Document # 870825

**Ground Lease Transfer**  
 The rights to the ground lease (held by the 4-H Council) on parcel 1990-001-900 was transferred to the Park District. Recorded on 12/01/2022 Document # 950535. The original ground lease commenced on 01/01/2021 and continues until 12/31/2099. Re-Recorded on 02/01/2021 Document # 917524

**Parking Lot**  
 Harlow's School Bus Service, Inc. has a Use Agreement to park up to 50 buses in the parking lot east of the rodeo arena from March 1st to May 1st in the years of 2022, 2023 and 2024.

**Rodeo Arena**  
 There are Use Agreements for the rodeo arena on Lot 18 Block 1 with:  
 1) North Dakota Horse Cutting Association  
 2) Central Dakota Rodeo Club Arena is rented per event. No end dates in the agreements.

**Community Garden**  
 There are 138 garden plots that can be leased. New leases each year.

**Lot 6 Block 1**  
 All of Lot 6 is owned by the City of Bismarck Waste Water Utility. The recorded easement granted to the City of Bismarck for a sanitary lift station covers the area of Lot 6 Block 1. Cannot find any other land transfer document. Recorded on 02/07/1974 Document # 253595

**Motocross Track Area**  
 Parts of Lots 12, 14 and 19 Block 1 is leased to the Bismarck Motocross Association for motocross use. The lease commenced on 04/01/2021 and runs through 03/31/2031. This lease may be terminated by either party upon 90 days written notice.

**Hay Lease**  
 Parts of Lots 4, 7, 13 and 19 Block 1 are leased to Arnie Zent for haying. The lease commenced on 05/01/2022 and runs through 12/31/2024.

**ATV Track Area**  
 There are Use Agreements for the ATV Track Area on parts of Lots 14 and 19 with:  
 1) The North Dakota Parks and Recreation Dept. The agreement includes the use of the ATV/Snowmobile Track and the gravel parking lot east of the rodeo arena. In addition an area near the south entrance to the complex can be used as a trailhead for the Roughrider Snowmobile Trail. Contract effective from 5/21/2022 to 3/31/2023  
 2) Dakota Boys and Girls Ranch  
 The agreement is for the dates of July 1st, July 8th, July 15th, Sept. 16th and Sept. 23rd 2022. It also allows for additional dates in only 2022.

**Bridge**  
 The bridge is owned by the North Dakota State Penitentiary. Agreement recorded on 01/27/1986 Document # 366290

**Lot 3 Block 1**  
 All of Lot 3 is owned by the State of North Dakota. The area of the lot is encompassed by the recorded Channel Change Easement the State transferred to the State Highway Department Recorded on 07/15/1981 Document # 323290 This is also shown on the Right of Way Plat Recorded on 08/20/1982 Document # 331399 This area was then not included in Burleigh County's purchase from the State by the Quiet Claim Deed Recorded on 03/31/1997 Document # 495740 because the deed was for land only owned by the State Penitentiary.

**Detention Center**  
 All of Lot 1 Block 1 is owned by Burleigh County but is used for the Burleigh/Morton County Detention Center

Not Owned By Burleigh County / The Detention Center  
 Leased Area  
 Subdivision Boundary  
 Lots

**\*\*All land in the Missouri Valley Complex, except lots 3 and 6, appears to be owned by Burleigh County through the following recorded document numbers: 382988, 401396, 422315, 495740 and 912232**

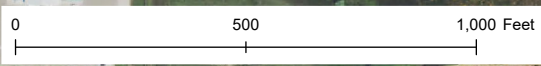



## Missouri Valley Complex Committee

The Missouri Valley Complex Committee formation was further clarified with the Burleigh County Commissioners and the following structure and operations were agreed to and approved on February 5, 2024, by the Commission.

The items for presentation and discussion are as follows:

### **Committee member compensation:**

- **The committee is a non-compensated committee.**

**The membership of the Missouri Valley Complex Committee be established as follows:**

**The Committee establishment would be an eleven (11) member committee.**

- Eight (8) members appointed by the stakeholder groups and three (3) residents of Burleigh County appointed by the Burleigh County Commission.

### **Stakeholder Membership:**

- The eight stakeholders are identified as those organizations who are operating by lease, facility ownership, with current program/event interest and with present development interests appoint one member each to the committee as their representative to the MVCC.
- The eight-stake holder members are not subject to application for review or individual appointment approval by the County Commission.

Reason: as stakeholder appointees they are representatives of their organization and following the practice of other agencies/organization appointed representatives to joint Boards, Committees and Commissions.

- The identified stakeholder groups of the Committee are as follows:

Buckstop Junction	Jr/Sr High Rodeo
Motor Cross	Stock Car Club
Equestrian/Ag Center	Extension Service
4H Council	Park District

## Missouri Valley Complex Committee

### **Burleigh County Resident Committee Appointments.**

- Three (3) committee members will be residents of Burleigh County and appointed by the Burleigh County Commission.
- The appointment process of the resident members is proposed to follow the current application practice of Burleigh County with a written application to serve submitted to the County Auditor and forwarded to the Commission for review and approval for appointment. The initial appointments will be for a 2, 3 and 4-year term.

### **Two (2) Board Liaison (Non-Voting) Members**

- The Burleigh County Commission liaison member would be the County Commissioner who holds the Missouri Valley Complex within their portfolio.
- The Bismarck Park Board Commissioner liaison member would be the Commissioner who holds the Missouri Valley Complex within their portfolio.

### **Administrative Support**

- The committee would engage as seen necessary Administrative Support from interested individuals and organizations to provide meeting scheduling agenda and notices, minutes, coordination of research and development and liaison relations.
- Administrative Support is not provided committee membership or voting privileges.

### **Item 3: Organization Chart**

- A Draft Organization Chart is provided indicating the committee membership and lines of responsibilities, relationships, and term considerations.

### **Item 4: Request for Commissioner Liaison Appointment.**

- The appointment of Commissioner Wayne Monson as Burleigh County Commission Liaison to the Missouri Valley Complex Committee was approved.

## Missouri Valley Complex Committee

### **Item 5: Discuss relationship of Committee to Burleigh County Staff and Resources.**

- The Committee has been provided permission to contact and work with county staff as an example County Auditor, County Engineer, Sheriff, and States Attorney when needs arise for such items as access to records and leases at the Complex, meeting scheduling, web site management, budget information for annual budget development, copies, insurance, contracts, planning, and history.
- The Committee has been granted permission to seek outside financial resources to support the operation, development and improvements at the Complex including grants and private fundraising.
- The Committee has been granted permission to seek new events and community offerings at the Complex.

# Missouri Valley Complex Committee

## **Action of establishment:**

The “Missouri Valley Complex Committee” (approved by Burleigh County Commission January 17, 2024) is established as a management, complex operation, and development oversight committee responsible to the Burleigh County Commission for the Missouri Valley Complex (MVCC).

## **Purpose:**

The establishment of the MVCC is to formally engage representatives of the organizations currently operating by lease, facility ownership and with program and development interest at the Missouri Valley Complex for the purpose of complex management and programming, site and facility improvements, and operations.

The MVCC may establish committees to develop projects and events in the interest of the Missouri Valley Complex, Burleigh County Commission, and community.

## **Membership:**

The membership of the MVCC includes: Buckstop Junction, Motor Cross, County Extension, 4H, HS/JR High Rodeo Club, Equestrian and Ag Center, Stock Car Club, the Bismarck Park District and 3 Burleigh County Commission appointees. The appointees shall be residents of Burleigh County.

The MVCC will be established as an 11-member management committee.

The MVCC will also include one non-voting liaison member from the Burleigh County Commission and Bismarck Park Board.

## **Tasks and Responsibilities:**

### **The tasks and responsibilities of the MVCC are:**

To develop and establish management and broad operating policies for planning, operating and project budgeting, and improvement plans for the Missouri Valley Complex within the policies of the Burleigh County Commission.

To ensure the organizations operating on the complex and those events held at the complex operate within the policies and interest of the Complex and Burleigh County Commission.

To develop an annual complex operating plan and budget for presentation to the County Commission to include programming schedule, event development and capital improvements.

To develop an annual complex operating and event report to the County Commission and public.

To provide oversight of complex planning and project review, engage operating and management services and professional services.

## Missouri Valley Complex Committee

To support the events and efforts of the membership at the Complex.

To provide oversight and review of leases and easements and make recommendations to County Commission.

To provide oversight of complex operation and management leases, event contracts and operations compliance.

To seek outside funding sources, grants and provide fundraising support individually and jointly.

To provide review of project development.

To assist in the review and development of new programs, events, fairs, and festivals at the complex, and,

To operate within policies and procedures of Burleigh County and be afforded access to resources available through the County Commission.

To meet at a minimum bi-monthly or at the call of the Chair with minutes and all meetings recorded.

To hold meetings at the Tom Baker Room in the interest of the public and broadcast all meetings on Dakota Media Access TV when possible. (In the event the Tom Baker Room is not available the meeting shall be recorded in the next available manner.)



## **2024 meeting schedule for the Missouri Valley Complex Committee**

April 23

May 14

June 5 (Wed)

June 25

July 17 (Wed)

August 6

August 27

September 17

October 8

October 30 (Wed)

November 19

December 10

December 31

Missouri Valley Complex Committee  
(MVCC)  
Meeting Agenda  
Tuesday May 14, 2024  
Tom Baker Room/City County Building 221 N 5<sup>th</sup> St Bismarck, ND

**12:00 P.M.**

Item 1. Call the Meeting to Order and Establish Quorum

Item 2. Approval of Minutes of April 24, 2024

Item 3. County Commissioner Munson Update.

County Action on Lease of Agriculture Land

Review of Current (2024) MVCC Budget

Update on Burleigh County Budget Process and Scheduling

Update on MVCC Planning and Plan Development

Item 4. Bismarck Planning Department Presentation: Daniel Nairn  
Current (PUD) Planned Unit Development zoning of MVC and is  
Public Zoning (P) an option for the MVC

Item 5. Discussion: MVCC Budget Considerations and Development Process

Item 6. Stakeholder Presentations

4H and Extension

Bismarck Park District

Item 7. Upcoming Stakeholder Events/Developing Master Schedule

Item 8. Next Meeting

Wednesday June 5<sup>th</sup> 12:00 Noon

Item 9. Meeting Adjourned.

Missouri Valley Complex Committee  
Minutes of April 23, 2024

Members Present: Marie Horning, Kay LaCoe, Missy Hilsendeger, Tyler Kralicek, Alan Heim, Scott Olson, Tom Peters, Distin Gwrylow, Kevin Klipfel, Commissioner Munson, Commissioner Jeske, Steve Neu.

Members Absent: Wayne Martineson

Commissioner Munson opened the meeting and welcomed all the members to the first official meeting of the Missouri Valley Complex Committee. The first official meeting due to the meeting held on April 3, 2024, which was not properly noticed published as required.

Commissioner Munson continued with introductions by the seated committee members and provided an overview of development of the MVCC and referenced the materials provided to the committee on formation, purpose and responsibilities as approved by the Burleigh County Commission. The MVCC is a recognized committee of the Burleigh County Commission with accountability to the Commission as other committees of Burleigh County. Commissioner Munson continued overview of the committee's roles and responsibilities, chain of command and that the committee represents the stakeholders with programs, facilities, and development interests in the complex. The representation on the committee provides an opportunity to work together as an operating group of the complex for a common good of the complex, supporting each other's programs and to work together for the improvement and development of the Missouri Valley Complex.

Election of Officers.

Commissioner Munson continued the meeting with the election of Chair, Vice-Chair and Secretary/Coordinator for the Committee

Chair – motion was made by M Horning to nominate Kay LaCoe as Chair of the MVCC. The motion was seconded by A Heim. Motion was approved.

Vice Chair – motion was made by M Horning to nominate Alan Heim as Vice Chair of the MVCC. The motion was seconded by T Peters. The Motion was approved.

Secretary/Coordinator – motion was made by M horning to nominate Steve Neu as Secretary /Coordinator of the MVCC. The motion was seconded by M Hilsendeger. Motion was approved.

Kay LaCoe was seated as Chair.

Chair LaCoe provided an overview of the operation of the MVCC including structure of 11 members, representation of stakeholder groups and that the only open position of Jr/HS Rodeo Club. Further overview was provided of the organization chart and accountability flow of the committee from stakeholder groups up to the committee and to the County Commission and Park Board for approvals of items relevant to the governing bodies.

Missouri Valley Complex Committee  
Minutes of April 23, 2024

County Auditor Splonskowski provided the committee with an overview of the ND Open Meetings Law and requirements of communication with the County Commission and quorum of the committee as a public Board. The open meeting laws do cover operations of both public elected and appointed boards and committees. It was also pointed out that the MVCC could establish short and long term need subcommittees to address specific issues over time or a topic for short term research and return to the full committee.

The committee discussed meeting operations and protocols of operation and agreed that “Roberts Rules of Order” would provide guidelines and guidance of meeting operations.

A Code of Conduct was also discussed for the operation of the MVCC and membership to include meeting conduct and attendance. This topic would be further discussed by the committee at a future meeting to establish a written document.

#### Overview of MVCC Leases

Auditor Splonskowski provided an overview of the current site leases and operating agreements at the complex and informed the committee that all leases and operating agreements are current and on file in his office. The lease for the ag land which was the corn field expired in 2023 and the County Commission had approved advertising for a new lease. Proposals will be reviewed at the May 6 meeting of the Commission.

#### Burleigh County Website

S Neu briefed the committee on conversations with Mary Senger, Burleigh County Emergency Manager and coordinator of the county web page on the MVC page developed for the MVCC and provide each stakeholder group opportunity to provide information on their organization, events and happenings. The final process of submitting information has not been formally set but will be distributed to the committee when it is ready. S Neu asked the committee to look at the county web site under Boards and Commissions for the information that is already available.

#### Meeting Schedule

Chair LaCoe briefed the committee on the meeting schedule that was provided and noted that the agreed meeting day was Tuesday except for conflicts the meeting was scheduled for Wednesday. The meeting location will be the Tom Baker Room or first floor conference room if a conflict exists.

Next meeting dates: May 14<sup>th</sup> and June 5<sup>th</sup>.



Missouri Valley Complex Committee  
Minutes of April 23, 2024

A question was raised about meeting attendance. A quorum is required to hold a meeting and at this time there is not a attendance requirement or allowable absences. An attendance requirement could be developed by the committee as part of the Code of Conduct.

Stakeholder Presentations.

It was the desire of the committee to have each stakeholder present an overview of their organization and information of operations, growth, needs, programming, events, and structure. The committee felt the information would be good to learn more about everyone's organization and impacts at the complex.

Presentations were scheduled for eh next three meetings as follows:

May 14 – 4H/Extension and Park District

June 5 – Moto Cross and Stock Car Club

June 25 – Equestrian/Ag Center

Along with the meeting and stakeholder presentation schedule a brief discussion was held on MVC budget development including budget presentation to County Budget Committee. All stakeholders will be involved in developing the complex budget at the committee level with development of common needs benefiting the complex to grow the programs and operations of the stakeholders.

Commissioner Munson provided a brief overview of the current complex operating budget of \$78,000

Stakeholder Presentation: Buck Stop Junctin

Missy Hilsendeger provided the overview and presentation on Buckstop Junction.

Missy reported that Buckstop Junction was established in 1992 with a purpose to create a visual location to remember and engage in the history of North Dakota and Burleigh County and preserve the structures of the past by creating a village.

Many events have been held at Buckstop Junction over the years from large community events to small gatherings, weddings, anniversaries, convention activity, and celebrations. Presently the number of events and sizes have dropped off and it is the desire of the Board to regrow the activity and promote a location to have affordable and interesting facilities to host events. But the membership of the board is "aging" out and the current members are working on recruiting new members and commitments to events and growing Buckstop Junction.

Issues: recruitment of board members and events/activity. Operating budget is driven by memberships, volunteers, donations, and rentals.

The facility itself needs infrastructure upgrades to include extending existing water and sewer Systems, graveling roads and blacktop surfaces. A major project being discussed is the development of a "barn" to host large events and provide events for other complex groups.

Missouri Valley Complex Committee  
Minutes of April 23, 2024

Missy looks forward to, along with the Buckstop Junction Board, being part of developing the synergy between the groups at the complex and seeing the complex developed.

Chair LaCoe, thank all the members of the Committee for their attendance and commitment to the MVCC and looked forward to working with everyone.

Next meeting Tuesday May 14<sup>th</sup>, 12:00 noon – Tom Baker Room.

Meeting adjourned.

**Missouri Valley Complex  
2022 Expenses**

Invoice	Inv. Date	Account	Vendor	Detail Line Description	Total
963	7/7/2022	2982.45210.00998	BAIN AGENCY	RENEWAL OF PROPERTY - FT POLICY 1095-02	108.00
1094	10/4/2022	2982.45210.00998	BAIN AGENCY	Updating property values	67.00
1094.1	11/4/2022	2982.45210.00998	BAIN AGENCY	Premium Revision	(59.00)
			<b>BAIN AGENCY Total</b>		\$ 116.00
762	1/18/2022	2982.45210.00998	BAIN INSURANCE AGENCY	Policy #FT1095-02 - 07/01/2021 - 07/01/2022 - Fixed Seating @ Racetrack	\$ (4.00)
762	1/18/2022	2982.45210.00998	BAIN INSURANCE AGENCY	Policy #FT1095-02 - 07/01/2021 - 07/01/2022 - Rodeo Announcer Booth	1.00
			<b>BAIN INSURANCE AGENCY Total</b>		\$ (3.00)
3265	1/5/2022	2982.45210.00382	BISMARCK PARKS AND RECREATION	December 2021 Missouri Valley Complex Contracted Services	\$ 59.54
3265	1/5/2022	2982.45210.00423	BISMARCK PARKS AND RECREATION	December 2021 Missouri Valley Complex Supplies & Materials	65.97
03467	4/8/2022	2982.45210.00382	BISMARCK PARKS AND RECREATION	MARCH 2022 MISSOURI VALLEY COMPLEX CONTRACTED SERVICES	573.50
03467	4/8/2022	2982.45210.00609	BISMARCK PARKS AND RECREATION	MARCH 2022 MISSOURI VALLEY COMPLEX CAPITAL EQUIPMENT	2,294.00
3516	5/12/2022	2982.45210.00382	BISMARCK PARKS AND RECREATION	APRIL 2022 MVC CONTRACTED SERVICES	339.50
3516	5/12/2022	2982.45210.00423	BISMARCK PARKS AND RECREATION	APRIL 2022 MVC SUPPLIES AND MATERIALS	24.50
3591	6/3/2022	2982.45210.00351	BISMARCK PARKS AND RECREATION	MAY 2022 MVC Utilities	3.27
3591	6/3/2022	2982.45210.00382	BISMARCK PARKS AND RECREATION	MAY 2022 MVC CONTRACTED SERVICES	229.23
3591	6/3/2022	2982.45210.00423	BISMARCK PARKS AND RECREATION	MAY 2022 MVC SUPPLIES AND MATERIALS	184.84
3686	7/6/2022	2982.45210.00351	BISMARCK PARKS AND RECREATION	JUNE 2022 MVC Utilities	108.09
3686	7/6/2022	2982.45210.00382	BISMARCK PARKS AND RECREATION	JUNE 2022 MVC Contracted Services	4,470.84
3686	7/6/2022	2982.45210.00423	BISMARCK PARKS AND RECREATION	JUNE 2022 MVC Supplies and Materials	1,349.32
3770	8/8/2022	2982.45210.00351	BISMARCK PARKS AND RECREATION	July 2022 MVC Utilities	17.94
3770	8/8/2022	2982.45210.00382	BISMARCK PARKS AND RECREATION	July 2022 MVC Contracted Services	5,619.97
3770	8/8/2022	2982.45210.00423	BISMARCK PARKS AND RECREATION	July 2022 MVC Supplies and Materials	1,000.67
3845	9/6/2022	2982.45210.00351	BISMARCK PARKS AND RECREATION	August 2022 MVC Utilities	19.34
3845	9/6/2022	2982.45210.00382	BISMARCK PARKS AND RECREATION	August 2022 MVC Contracted Services	4,320.80
3845	9/6/2022	2982.45210.00423	BISMARCK PARKS AND RECREATION	August 2022 MVC Supplies and Materials	1,522.11
3887	10/4/2022	2982.45210.00351	BISMARCK PARKS AND RECREATION	September 2022 MVC Utilities	59.17
3887	10/4/2022	2982.45210.00382	BISMARCK PARKS AND RECREATION	September 2022 MVC Contracted Services	2,716.61
3887	10/4/2022	2982.45210.00423	BISMARCK PARKS AND RECREATION	September 2022 MVC Supplies and Materials	251.70
03973	11/3/2022	2982.45210.00351	BISMARCK PARKS AND RECREATION	October 2022 MVC Utilities	11.05
03973	11/3/2022	2982.45210.00382	BISMARCK PARKS AND RECREATION	October 2022 MVC Contracted Services	1,670.40
03973	11/3/2022	2982.45210.00423	BISMARCK PARKS AND RECREATION	October 2022 MVC Supplies and Materials	1,389.11
4002	12/1/2022	2982.45210.00382	BISMARCK PARKS AND RECREATION	November 2022 MVC Contracted Services	397.15
4002	12/1/2022	2982.45210.00423	BISMARCK PARKS AND RECREATION	November 2022 MVC Supplies and Materials	292.83
			<b>BISMARCK PARKS AND RECREATION Total</b>		\$ 28,991.45
05242022	5/24/2022	2982.45210.00884	BURLEIGH COUNTY 4H COUNCIL	2022 4-H Premium Money - 4-H FAIR	\$ 3,000.00
			<b>BURLEIGH COUNTY 4H COUNCIL Total</b>		\$ 3,000.00

**Missouri Valley Complex  
2022 Expenses**

2021120103	12/28/2021	2982.45210.00351	CAPITAL ELECTRIC COOP	11/01/21 - 12/01/21 - Bis Expy Sign	\$	63.02
2021120104	12/28/2021	2982.45210.00351	CAPITAL ELECTRIC COOP	11/01/21 - 12/01/21 - Sct 1 RC 13 M		46.00
2021120105	12/28/2021	2982.45210.00351	CAPITAL ELECTRIC COOP	11/01/21 - 12/01/21 - Sct 1 SW RC 13M		52.00
1487809-011022	1/10/2022	2982.45210.00351	CAPITAL ELECTRIC COOP	12/01/21 - 01/01/22 - MO Valley Fair Section 1 Race Track		59.18
2022010123	1/21/2022	2982.45210.00351	CAPITAL ELECTRIC COOP	2021 - 12/01/21 - 01/01/22 - Bis Expy Sign		58.90
2022010124	1/21/2022	2982.45210.00351	CAPITAL ELECTRIC COOP	2021 - 12/01/21 - 01/01/22 - Sct 1 RC 13 M		46.00
2022010125	1/21/2022	2982.45210.00351	CAPITAL ELECTRIC COOP	2021 - 12/01/21 - 01/01/22 - Sct 1 SW RC 13M		52.00
1487809-020722	2/7/2022	2982.45210.00351	CAPITAL ELECTRIC COOP	01/01/22 - 02/01/22 - MO Valley Fair Section 1 Race Track		59.18
2022020113	2/18/2022	2982.45210.00351	CAPITAL ELECTRIC COOP	1/1/22 - 2/1/22 - Bis Expy Sign		59.17
2022020114	2/18/2022	2982.45210.00351	CAPITAL ELECTRIC COOP	1/1/22 - 2/1/22 - Sct 1 RC 13 M		46.00
2022020115	2/18/2022	2982.45210.00351	CAPITAL ELECTRIC COOP	1/1/22 - 2/1/22 - Sct 1 SW RC 13 M		52.00
1487809-030722	3/7/2022	2982.45210.00351	CAPITAL ELECTRIC COOP	02/01/22 - 03/01/22 - MO Valley Fair Section 1 Race Track		59.18
2022030106	3/14/2022	2982.45210.00351	CAPITAL ELECTRIC COOP	2/1/22 - 3/1/22 - Bis Expy Sign		57.64
2022030107	3/14/2022	2982.45210.00351	CAPITAL ELECTRIC COOP	2/1/22 - 3/1/22 - Sct 1 RC 13 M		46.00
2022030108	3/14/2022	2982.45210.00351	CAPITAL ELECTRIC COOP	2/1/22 - 3/1/22 - Sct 1 SW RC 13M		52.00
1487809-040722	4/7/2022	2982.45210.00351	CAPITAL ELECTRIC COOP	03/01/22 - 04/01/22 - MO Valley Fair Section 1 Race Track		59.18
2022040090	4/11/2022	2982.45210.00351	CAPITAL ELECTRIC COOP	3/1/22 - 4/1/22 - Bis Expy Sign		63.91
2022040091	4/11/2022	2982.45210.00351	CAPITAL ELECTRIC COOP	3/1/22 - 4/1/22 - Sct 1 RC 13 M		46.00
2022040092	4/11/2022	2982.45210.00351	CAPITAL ELECTRIC COOP	3/1/22 - 4/1/22 - Sct 1 SW RC 13M		52.00
2022050120	5/11/2022	2982.45210.00351	CAPITAL ELECTRIC COOP	APRIL CHARGES - BOS EXPY SIGN		64.63
2022050121	5/11/2022	2982.45210.00351	CAPITAL ELECTRIC COOP	APRIL CHARGES - SCT 1 SW RC 13 M		46.00
2022050122	5/11/2022	2982.45210.00351	CAPITAL ELECTRIC COOP	APRIL CHARGES - SCT 1 SW RC 13M		52.00
1487809 050622	5/12/2022	2982.45210.00351	CAPITAL ELECTRIC COOP	04/01/22 - 05/01/22 - MO Valley Fair Section 1 Race Track		63.82
1487809 060722	6/7/2022	2982.45210.00351	CAPITAL ELECTRIC COOP	05/01/22 - 06/01/22 - MO Valley Fair Section 1 Race Track		245.18
2022060091	6/21/2022	2982.45210.00351	CAPITAL ELECTRIC COOP	MAY 2022 - BIS EXPY SIGN		80.77
2022060092	6/21/2022	2982.45210.00351	CAPITAL ELECTRIC COOP	MAY 2022 - Sct 1 RC 13 M		49.00
2022060093	6/21/2022	2982.45210.00351	CAPITAL ELECTRIC COOP	MAY 2022 - Sct 1 SW RC 13M		112.00
1487809 070822	7/8/2022	2982.45210.00351	CAPITAL ELECTRIC COOP	06/01/22 - 07/01/22 - MO Valley Fair Section 1 Race Track		83.24
2022070112	7/13/2022	2982.45210.00351	CAPITAL ELECTRIC COOP	June - Bis Expy Sign		83.10
2022070113	7/13/2022	2982.45210.00351	CAPITAL ELECTRIC COOP	June - Sct 1 RC 13 M		49.00
2022070114	7/13/2022	2982.45210.00351	CAPITAL ELECTRIC COOP	June - Sct 1 SW RC 13M		55.00
1487809 080522	8/5/2022	2982.45210.00351	CAPITAL ELECTRIC COOP	07/01/22 - 08/01/22 - MO Valley Fair Section 1 Race Track		92.52
2022080102	8/10/2022	2982.45210.00351	CAPITAL ELECTRIC COOP	July 2022 - Bis Expy Sign		84.56
2022080103	8/10/2022	2982.45210.00351	CAPITAL ELECTRIC COOP	July 2022 - Sct 1 RC 13 M		49.00
2022080104	8/10/2022	2982.45210.00351	CAPITAL ELECTRIC COOP	July 2022 - Sct 1 SW RC 13M		55.00
1487809 090922	9/9/2022	2982.45210.00351	CAPITAL ELECTRIC COOP	08/01/22 - 09/01/22 - MO Valley Fair Section 1 Race Track		64.68
202209300086	9/16/2022	2982.45210.00351	CAPITAL ELECTRIC COOP	August 2022 - Bis Expy Sign		83.27
202209300087	9/16/2022	2982.45210.00351	CAPITAL ELECTRIC COOP	August 2022 - Sct 1 RC 13 M		49.00
202209300088	9/16/2022	2982.45210.00351	CAPITAL ELECTRIC COOP	August 2022 - Sct 1 SW RC 13M		127.00
1487809 100722	10/7/2022	2982.45210.00351	CAPITAL ELECTRIC COOP	09/01/22 - 10/01/22 - MO Valley Fair Section 1 Race Track		64.68
2022100105	10/21/2022	2982.45210.00351	CAPITAL ELECTRIC COOP	September 2022 - Bis Expy Sign		79.48
2022100106	10/21/2022	2982.45210.00351	CAPITAL ELECTRIC COOP	September 2022 - Sct 1 RC 13 M		49.00



**Missouri Valley Complex  
2022 Expenses**

2022100107	10/21/2022	2982.45210.00351	CAPITAL ELECTRIC COOP	August 2022 - Sct 1 SW RC 13M	55.00
1487809 11082022	11/8/2022	2982.45210.00351	CAPITAL ELECTRIC COOP	10/01/22 - 11/01/22 - MO Valley Fair Section 1 Race Track	64.68
2022110106	11/25/2022	2982.45210.00351	CAPITAL ELECTRIC COOP	October 2022 - Bis Expy Sign	71.47
2022110107	11/25/2022	2982.45210.00351	CAPITAL ELECTRIC COOP	October 2022 - Sct 1 RC 13 M	49.00
2022110108	11/25/2022	2982.45210.00351	CAPITAL ELECTRIC COOP	October 2022 - Sct 1 SW RC 13M	55.00
1487809 120922	12/9/2022	2982.45210.00351	CAPITAL ELECTRIC COOP	11/01/22 - 12/01/22 - MO Valley Fair Section 1 Race Track	64.68
2022120117	12/23/2022	2982.45210.00351	CAPITAL ELECTRIC COOP	November 2022 - Bis Expy Sign	61.14
2022120118	12/23/2022	2982.45210.00351	CAPITAL ELECTRIC COOP	November 2022 - Sct 1 RC 13 M	49.00
2022120119	12/23/2022	2982.45210.00351	CAPITAL ELECTRIC COOP	November 2022 - Sct 1 SW RC 13M	55.00
			<b>CAPITAL ELECTRIC COOP Total</b>		\$ 3,336.26
2021120136	12/20/2021	2982.45210.00351	CITY OF BISMARCK	November Garden Meter - Water	\$ 39.57
2022060121	6/20/2022	2982.45210.00351	CITY OF BISMARCK	ACCT 63107000-000 MAY 2022	84.39
2022060125	6/20/2022	2982.45210.00351	CITY OF BISMARCK	ACCT 63118900-000 MAY 2022	72.56
2022070144	7/11/2022	2982.45210.00351	CITY OF BISMARCK	June Garden Mtr - Water	680.69
2022070147	7/11/2022	2982.45210.00351	CITY OF BISMARCK	June Fairgrounds - Water	231.23
2022080133	8/11/2022	2982.45210.00351	CITY OF BISMARCK	July Fairgrounds - Water	25.66
2022080134	8/11/2022	2982.45210.00351	CITY OF BISMARCK	July Garden Mtr - Water	888.39
202209300115	9/8/2022	2982.45210.00351	CITY OF BISMARCK	August Garden Mtr - Water	1,089.39
202209300117	9/8/2022	2982.45210.00351	CITY OF BISMARCK	August Fairgrounds - Water	59.16
2022100118	10/6/2022	2982.45210.00351	CITY OF BISMARCK	September Fairgrounds - Water	25.66
2022100121	10/6/2022	2982.45210.00351	CITY OF BISMARCK	September Garden Mtr- Water	419.39
2022110119	11/22/2022	2982.45210.00351	CITY OF BISMARCK	October Fairgrounds - Water	25.66
2022110122	11/22/2022	2982.45210.00351	CITY OF BISMARCK	October Garden Mtr- Water	70.99
			<b>CITY OF BISMARCK Total</b>		\$ 3,712.74
2022070161	7/21/2022	2982.45210.00423	DAKOTA AWARDS	Invoice #2207268 - Name Plate - Jeffery Herman	\$ 16.00
			<b>DAKOTA AWARDS Total</b>		\$ 16.00
			<b>Grand Total</b>		\$ 39,169.45

**Missouri Valley Complex  
2023 Expenses**

Invoice	Inv. Date	Account	Vendor	Detail Line Description	Total
1555	6/21/2023	2982.45210.00998	BAIN AGENCY	Renewal - Building and Contents - FT Policy 1095-04	\$ 183.33
			<b>BAIN AGENCY Total</b>		\$ 183.33
4775	11/9/2023	2982.45210.00351	BISMARCK PARKS AND RECREATION	October 2023 MVC Utilities	62.93
4703	10/3/2023	2982.45210.00351	BISMARCK PARKS AND RECREATION	September 2023 MVC Utilities	114.91
4646	9/6/2023	2982.45210.00351	BISMARCK PARKS AND RECREATION	August 2023 MVC Utilities	19.49
4567	8/4/2023	2982.45210.00351	BISMARCK PARKS AND RECREATION	July 2023 MVC Utilities	19.35
04528	7/13/2023	2982.45210.00351	BISMARCK PARKS AND RECREATION	June 2023 MVC Utilities	21.71
4471	6/19/2023	2982.45210.00351	BISMARCK PARKS AND RECREATION	May 2023 MVC Utilities	7.18
4823	12/4/2023	2982.45210.00382	BISMARCK PARKS AND RECREATION	November 2023 MVC Contracted Services	1,258.16
4775	11/9/2023	2982.45210.00382	BISMARCK PARKS AND RECREATION	October 2023 MVC Contracted Services	2,362.64
4703	10/3/2023	2982.45210.00382	BISMARCK PARKS AND RECREATION	September 2023 MVC Contracted Services	4,398.08
4646	9/6/2023	2982.45210.00382	BISMARCK PARKS AND RECREATION	August 2023 MVC Contracted Services	6,318.61
4567	8/4/2023	2982.45210.00382	BISMARCK PARKS AND RECREATION	July 2023 MVC Contracted Services	6,431.25
04528	7/13/2023	2982.45210.00382	BISMARCK PARKS AND RECREATION	June 2023 MVC Contracted Services	9,541.57
4471	6/19/2023	2982.45210.00382	BISMARCK PARKS AND RECREATION	May 2023 MVC Contracted Services	1,318.53
04086	1/11/2023	2982.45210.00382	BISMARCK PARKS AND RECREATION	December 2022 MVC Contracted Services	296.69
4823	12/4/2023	2982.45210.00423	BISMARCK PARKS AND RECREATION	November 2023 MVC Supplies & Materials	1,394.53
4775	11/9/2023	2982.45210.00423	BISMARCK PARKS AND RECREATION	October 2023 MVC Supplies & Materials	1,616.29
4703	10/3/2023	2982.45210.00423	BISMARCK PARKS AND RECREATION	September 2023 MVC Supplies & Materials	977.31
4646	9/6/2023	2982.45210.00423	BISMARCK PARKS AND RECREATION	August 2023 MVC Supplies & Materials	2,768.58
4567	8/4/2023	2982.45210.00423	BISMARCK PARKS AND RECREATION	July 2023 MVC Supplies & Materials	3,184.64
04528	7/13/2023	2982.45210.00423	BISMARCK PARKS AND RECREATION	June 2023 MVC Supplies & Materials	3,457.22
4471	6/19/2023	2982.45210.00423	BISMARCK PARKS AND RECREATION	May 2023 MVC Supplies & Materials	372.43
			<b>BISMARCK PARKS AND RECREATION Total</b>		\$ 45,942.10
1487806-120623	12/6/2023	2982.45210.00351	CAPITAL ELECTRIC COOP	11/01/23 - 12/01/23 - Sct 1 SW RC 13M	\$ 96.00
1487809-120623	12/6/2023	2982.45210.00351	CAPITAL ELECTRIC COOP	11/01/23 - 12/01/23 - MO Valley Fair Section 1 Race Track	65.24
2023110294	11/15/2023	2982.45210.00351	CAPITAL ELECTRIC COOP	October 2023 - Bis Expy Sign	70.77
2023110295	11/15/2023	2982.45210.00351	CAPITAL ELECTRIC COOP	October 2023 - Sct 1 RC 13 M	38.00
1487806-110623	11/6/2023	2982.45210.00351	CAPITAL ELECTRIC COOP	10/01/23 - 11/01/23 - Sct 1 SW RC 13M	93.00
1487809-110623	11/6/2023	2982.45210.00351	CAPITAL ELECTRIC COOP	10/01/23 - 11/01/23 - MO Valley Fair Section 1 Race Track	69.88
2023100415	10/20/2023	2982.45210.00351	CAPITAL ELECTRIC COOP	September 2023 - Bis Expy Sign	78.85
2023100416	10/20/2023	2982.45210.00351	CAPITAL ELECTRIC COOP	September 2023 - Sct 1 RC 13 M	38.00
1487806-100523	10/5/2023	2982.45210.00351	CAPITAL ELECTRIC COOP	09/01/23 - 10/01/23 - Sct 1 SW RC 13M	108.00
1487809-100523	10/5/2023	2982.45210.00351	CAPITAL ELECTRIC COOP	09/01/23 - 10/01/23 - MO Valley Fair Section 1 Race Track	79.16
2023090438	9/25/2023	2982.45210.00351	CAPITAL ELECTRIC COOP	August 2023 - Bis Expy Sign	81.87
2023090439	9/25/2023	2982.45210.00351	CAPITAL ELECTRIC COOP	August 2023 - Sct 1 RC 13 M	38.00
1487806-090723	9/7/2023	2982.45210.00351	CAPITAL ELECTRIC COOP	08/01/23 - 09/01/23 - Sct 1 SW RC 13M	446.00
1487809-090723	9/7/2023	2982.45210.00351	CAPITAL ELECTRIC COOP	08/01/23 - 09/01/23 - MO Valley Fair Section 1 Race Track	83.80
2023080424	8/21/2023	2982.45210.00351	CAPITAL ELECTRIC COOP	July 2023 - Bis Expy Sign	83.09
2023080425	8/21/2023	2982.45210.00351	CAPITAL ELECTRIC COOP	July 2023 - Sct 1 RC 13 M	38.00
1487806-080723	8/7/2023	2982.45210.00351	CAPITAL ELECTRIC COOP	07/01/23 - 08/01/23 - Sct 1 SW RC 13M	151.00

**Missouri Valley Complex  
2023 Expenses**

1487809-080723	8/7/2023	2982.45210.00351	CAPITAL ELECTRIC COOP	07/01/23 - 08/01/23 - MO Valley Fair Section 1 Race Track	83.80
2023070358	7/20/2023	2982.45210.00351	CAPITAL ELECTRIC COOP	June 2023 - Bis Expy Sign	81.71
2023070359	7/20/2023	2982.45210.00351	CAPITAL ELECTRIC COOP	June 2023 - Sct 1 RC 13 M	38.00
1487806-070723	7/7/2023	2982.45210.00351	CAPITAL ELECTRIC COOP	06/01/23 - 07/01/23 - Sct 1 SW RC 13M	93.00
1487809-070723	7/7/2023	2982.45210.00351	CAPITAL ELECTRIC COOP	06/01/23 - 07/01/23 - MO Valley Fair Section 1 Race Track	65.64
2023060443	6/14/2023	2982.45210.00351	CAPITAL ELECTRIC COOP	May 2023 - Bis Expy Sign	81.46
2023060444	6/14/2023	2982.45210.00351	CAPITAL ELECTRIC COOP	May 2023 - Sct 1 RC 13 M	38.00
1487806-060623	6/6/2023	2982.45210.00351	CAPITAL ELECTRIC COOP	05/01/23 - 06/01/23 - Sct 1 SW RC 13M	486.00
1487809-060623	6/6/2023	2982.45210.00351	CAPITAL ELECTRIC COOP	05/01/23 - 06/01/23 - MO Valley Fair Section 1 Race Track	87.32
2023050473	5/16/2023	2982.45210.00351	CAPITAL ELECTRIC COOP	April 2023 - Bis Expy Sign	67.51
2023050474	5/16/2023	2982.45210.00351	CAPITAL ELECTRIC COOP	April 2023 - Sct 1 RC 13 M	49.00
1487806-050523	5/5/2023	2982.45210.00351	CAPITAL ELECTRIC COOP	04/01/23 - 05/01/23 - Sct 1 SW RC 13M	265.00
1487809-050523	5/5/2023	2982.45210.00351	CAPITAL ELECTRIC COOP	04/01/23 - 05/01/23 - MO Valley Fair Section 1 Race Track	83.24
2023040384	4/18/2023	2982.45210.00351	CAPITAL ELECTRIC COOP	March 2023 - Bis Expy Sign	63.64
2023040385	4/18/2023	2982.45210.00351	CAPITAL ELECTRIC COOP	March 2023 - Sct 1 RC 13 M	49.00
1487806-040623	4/6/2023	2982.45210.00351	CAPITAL ELECTRIC COOP	03/01/23 - 04/01/23 - Sct 1 SW RC 13M	75.00
1487809-040623	4/6/2023	2982.45210.00351	CAPITAL ELECTRIC COOP	03/01/23 - 04/01/23 - MO Valley Fair Section 1 Race Track	64.68
2023030062	3/20/2023	2982.45210.00351	CAPITAL ELECTRIC COOP	February 2023 - Bis Expy Sign	59.50
2023030063	3/20/2023	2982.45210.00351	CAPITAL ELECTRIC COOP	February 2023 - Sct 1 RC 13 M	49.00
1487806-030423	3/4/2023	2982.45210.00351	CAPITAL ELECTRIC COOP	02/01/23 - 03/01/23 - Sct 1 SW RC 13M	75.00
1487809-030423	3/4/2023	2982.45210.00351	CAPITAL ELECTRIC COOP	02/01/23 - 03/01/23 - MO Valley Fair Section 1 Race Track	64.68
2023020405	2/23/2023	2982.45210.00351	CAPITAL ELECTRIC COOP	January 2023 - Bis Expy Sign	60.62
2023020406	2/23/2023	2982.45210.00351	CAPITAL ELECTRIC COOP	January 2023 - Sct 1 RC 13 M	49.00
1487806 020423	2/4/2023	2982.45210.00351	CAPITAL ELECTRIC COOP	01/01/23 - 02/01/23 - Sct 1 SW RC 13M	75.00
1487809 020423	2/4/2023	2982.45210.00351	CAPITAL ELECTRIC COOP	01/01/23 - 02/01/23 - MO Valley Fair Section 1 Race Track	64.68
2023010409	1/19/2023	2982.45210.00351	CAPITAL ELECTRIC COOP	December 2022 - Bis Expy Sign	60.28
2023010410	1/19/2023	2982.45210.00351	CAPITAL ELECTRIC COOP	December 2022 - Sct 1 RC 13 M	49.00
2023010411	1/19/2023	2982.45210.00351	CAPITAL ELECTRIC COOP	December 2022 - Sct 1 SW RC 13M	55.00
1487809 010623	1/6/2023	2982.45210.00351	CAPITAL ELECTRIC COOP	12/01/22 - 01/01/23 - MO Valley Fair Section 1 Race Track	64.68
			<b>CAPITAL ELECTRIC COOP Total</b>		\$ 4,157.10
2023110194	11/10/2023	2982.45210.00351	CITY OF BISMARCK	October - Garden Mtr - Water	\$ 51.76
2023110197	11/10/2023	2982.45210.00351	CITY OF BISMARCK	October - Fairgrounds - Water	18.82
2023100357	10/16/2023	2982.45210.00351	CITY OF BISMARCK	September - Garden Mtr - Water	114.13
2023100360	10/16/2023	2982.45210.00351	CITY OF BISMARCK	September - Fairgrounds - Water	21.79
2023090403	9/13/2023	2982.45210.00351	CITY OF BISMARCK	August - Fairgrounds - Water	36.64
2023090404	9/13/2023	2982.45210.00351	CITY OF BISMARCK	August - Garden Mtr - Water	188.38
2023080384	8/16/2023	2982.45210.00351	CITY OF BISMARCK	July - Fairgrounds - Water	21.79
2023080385	8/16/2023	2982.45210.00351	CITY OF BISMARCK	July - Garden Mtr - Water	310.15
2023070311	7/14/2023	2982.45210.00351	CITY OF BISMARCK	June Garden Mtr - Water	224.02
2023070312	7/14/2023	2982.45210.00351	CITY OF BISMARCK	June Fairgrounds - Water	24.76
2023060453	6/14/2023	2982.45210.00351	CITY OF BISMARCK	May Garden Mtr - Water	75.52
2023060455	6/14/2023	2982.45210.00351	CITY OF BISMARCK	May Fairgrounds - Water	30.70

**Missouri Valley Complex  
2023 Expenses**

2023002762	9/30/2023	2982.45210.00382	<b>CITY OF BISMARCK Total</b>		\$ 1,118.46
			ICON ARCHITECTURAL GROUP	Project 22-089 Burleigh County Equestrian Center - Phase I Feasibility Study - Study for Equest	\$ 9,000.00
			<b>ICON ARCHITECTURAL GROUP Total</b>		\$ 9,000.00
			<b>Grand Total</b>		\$ 60,400.99



Missouri Valley Complex Committee  
(MVCC)

Meeting Agenda

Wednesday June 5, 2024

Tom Baker Room/City-County Building 221 N 5<sup>th</sup> St Bismarck ND

12:00 NOON

Item 1. Call the Meeting to Order and Establish Quorum

Item 2. Approval of Minutes of May 14, 2024, Meeting

Item 3. Commissioner Munson Update and Briefing

Review of Current (2024) MVCC Budget

Update on Burleigh County Budget Process, Development, and Schedule

Update on MVCC Planning Process and Site Plan Development

Item 4. Commissioner Munson: Presentation and Discussion with Swenson, Hagen & Company regarding MVCC Site Plan Development

Item 5. Discussion on MVCC Current (PUD) Planned Unit Development Zoning and Consideration of Rezoning to (P) Public Zoning

Item 6. Next Meeting

Tuesday June 25, 2024. 12:00 Noon.

Item 7. Meeting Adjourned

Missouri Valley Complex Committee  
(MVCC)  
Meeting Agenda  
Tuesday June 25, 2024, 12:00 Noon  
221 N 5th St Bismarck ND  
First Floor Conference Room

Item 1. Call the meeting to order.

Item 2. Approval of Minutes from June 5 Meeting.

Item 3. Briefing: Commissioner Munson

2025 MVCC Budget Development and Budget Hearing Schedule

Planning and Development:

Swenson-Hagen MVCC Site Plan Development Proposal

Item 4. Stakeholder Presentation

Burleigh County Equestrian and Ag Center Project Development

Item 6. Discussion of Meeting Schedule Through December 2024

Item 7. Next Meeting: Wednesday July 17, 12:00 Noon

Item 8. Meeting Adjourned

Missouri Valley Complex Committee  
(MVCC)  
Meeting Agenda  
Tuesday August 6, 2024, 12:00 Noon  
Tom Baker Room/City County Building-221 N 5<sup>th</sup> St, Bismarck, ND

Item 1. Call the meeting to order and Roll Call.

Item 2. Approval of June 25, 2024, meeting minutes.

Item 3. Commissioner Munson Briefing

Update on County Commission Action – July 15, 2024  
Swenson Hagen Services Contract and Funding  
Plat update and changing from PUD to P(Public)  
Initiating Planning Process

2025 Missouri Valley Complex Operating Budget Introduction

Item 4. Swenson Hagen Engineering – Overview of Plat Review Schedule and MVCC Stakeholders Engagement

Item 5. Auditor Splonskowski – Overview of Missouri Valley Complex Fund, Balance, and Interest Earnings

Item 6. Using the County Web Site – Mary Senger, Burleigh County Web Page Manger

Item 7. Discussion of staggered committee membership of stakeholder appointments

Item 8. Proposed MVCC meeting schedule through December 2024.

Item 9. Consideration to hold September meeting at MVC. Location TBD.

Item 10. Meeting Adjourned.

Missouri Valley Complex Committee  
(MVCC)  
Meeting Agenda  
Tuesday September 17, 2024, 12:00 Noon  
NDSU Extension Office-Joann Hetzel Memorial Building  
3715 E Bismarck Expressway, Bismarck, ND

Item 1. Approval of Minutes of August 6, 2024, Meeting

Item 2. Commissioner Munson Briefing

2025 Budget Development

Presentation on small car racing/track usage

Item 3. Swenson – Hagen Engineering

MVCC Replat Discussion and Initial Committee Input Session.

Item 4. Next Meeting – Tuesday October 8, 2024

Missouri Valley Complex Committee  
(MVCC)  
Meeting Agenda  
Tuesday October 29, 2024, 12:00 Noon  
Tom Baker Meeting Room  
City County Building 221 N 5<sup>th</sup> St. Bismarck, ND

1. Call Meeting to Order
2. Approval of Minutes – September 17, 2024
3. Commissioner Munson Briefing.
4. Update and Discussion of Missouri Valley Complex Fund Review
5. Update and Review of Rezoning of Missouri Valley Complex – Swenson Hagen
6. Next Meeting – November 19, 2024 – Tom Baker Room



Missouri Valley Complex Committee  
(MVCC)  
Meeting Agenda  
Tuesday November 19, 2024, 12:00 Noon  
Tom Baker Meeting Room  
City/County Building 221 N 5<sup>th</sup> St. Bismarck, ND

1. Call the to Order
2. Approval of Minutes – October 29, 2024
3. Commissioner Munson Update
4. Update and Discussion of Missouri Valley Complex Fund Review
5. Update and Review of Rezoning Progress and Platting of Missouri Valley Complex.
6. MVCC Appointments, Clarification of Initial Terms and Requirements for Upcoming County Commission Reorganization
7. Next Meeting : December 10, 2024

Missouri Valley Complex Committee  
(MVCC)  
Meeting Agenda  
Tuesday December 3, 2024, 6:30 pm  
Buckstop Junction - Lewis and Clark Hotel  
3805 E Bismarck Expressway, Bismarck, ND

1. Call the meeting to order.
2. Commissioner Munson Briefing
3. Update on Missouri Valley Complex Rezoning
4. Committee Plat Discussion and Infrastructure Development of Missouri Valley Complex.
5. Discussion: Leases, Operating, and Development Agreements.
6. Discussion: 2025 Meeting Schedule